

Contact (part 1)

Jenny Baines, Sophie Clements, Carali McCall & Cathy Rogers

curated by Andrew Vallance

July 20 – August 17, 2024

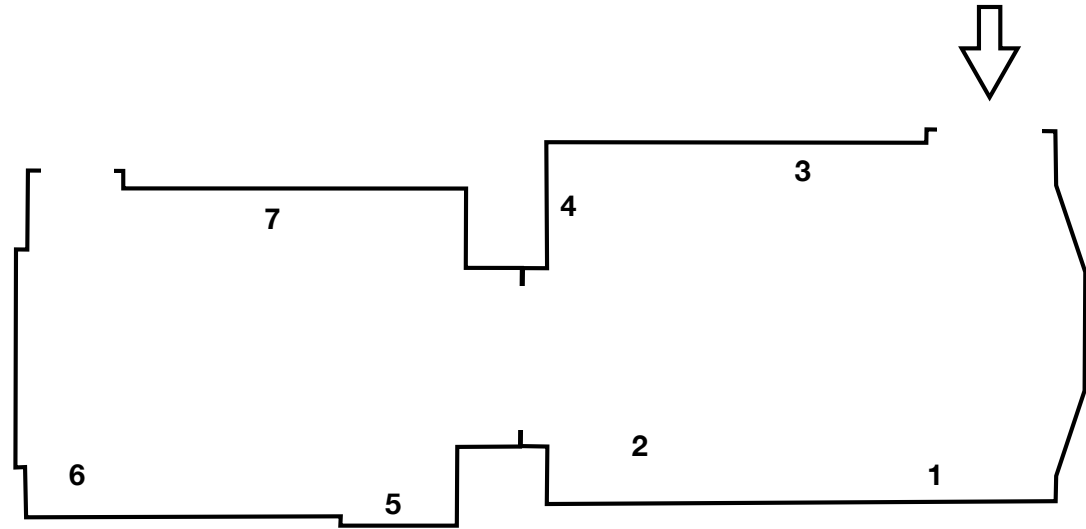
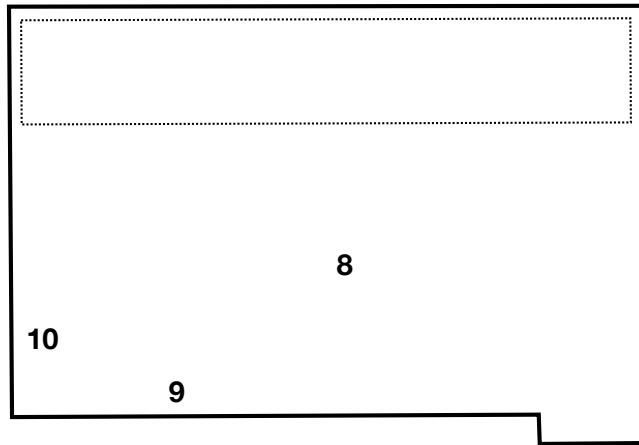

1. Carali McCall
Shoulder Sculpture I (contact), 2024
Plaster, papier-mâché, cardboard

2. Sophie Clements
Come to Ground (Surrender), 2023
Survival blanket, metal pole & stand, electric fan

3. Cathy Rogers
Stipa Gigantea II, 2024
16mm film, LED light panel

4. Jenny Baines
Centre and Measure #1, 2024
Hand-printed medium format photograph with photogram

5. Cathy Rogers
Miscanthus, 2024
16mm film, LED light panel

6. Sophie Clements
Come to Ground (Battles), 2023
Video, monitors x3, DVD players

7. Carali McCall
Circle Drawing 1h58min, 2012-24
Graphite on paper (live performance)

8. Jenny Baines
Method over Matter #3, 2024
16mm film, 16mm projector, painted steel frame and
geometric floor pieces, paper, magnets

9. Cathy Rogers
Leylandii, 2022
16mm film, LED light panel

10. Carali McCall
Shoulder Sculpture II (contact), 2024
Plaster, papier-mâché, cardboard