

## Contact (part 2)

Savinduer Bual, Jim Hobbs, Simon Payne & Andrew Vallance  
curated by Andrew Vallance

January 18 – February 8, 2025

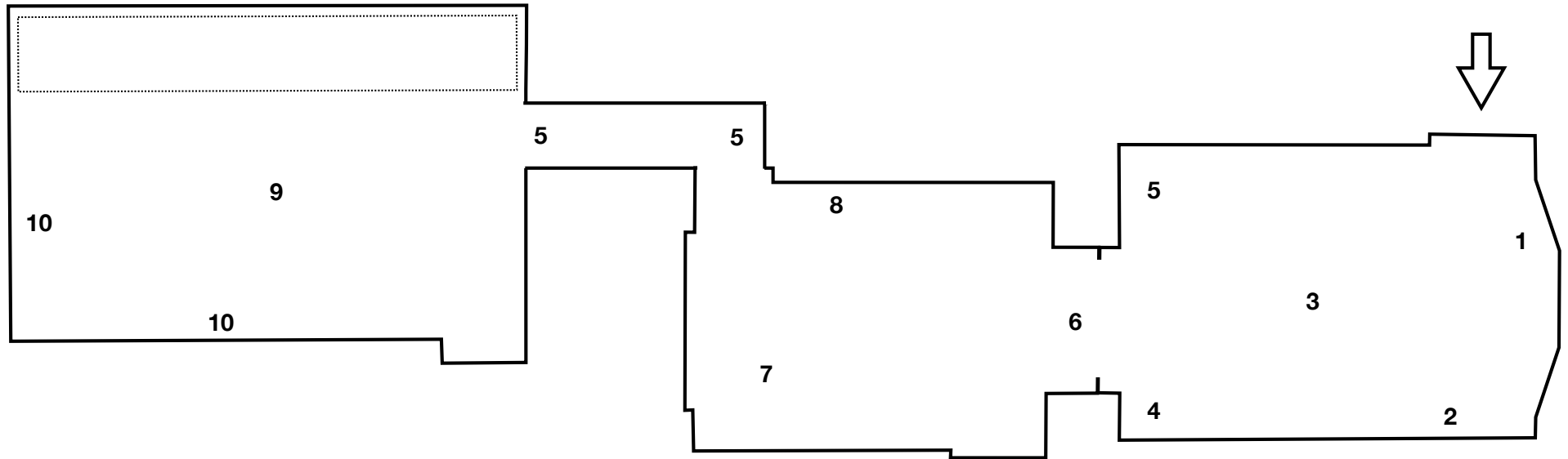

1. Savinder Bual  
*De-Extinction*, 2025  
Monitor, video
2. Andrew Vallance  
*Clew*, 2025  
LED lightbox, photographic transparency, birch faced ply, perspex
3. Savinder Bual & Elena Blanco  
*A Different Lens*, 2024  
Wire mesh, glass, steel, wood, magnets
4. Jim Hobbs  
*(mis)alignment*, 2024  
Pencil, ink, tape on graph paper
5. Jim Hobbs  
*Polytechniou - When the Order breaks the Fractures Lull*, 2025  
CRT monitor, video, black and white
6. Simon Payne  
*Floor Piece*, 2025  
Projectors, video, colours
7. Andrew Vallance  
*Never Still*, 2025  
Seven LED lightboxes, photographic transparency, birch faced ply, perspex
8. Savinduer Bual & Elena Blanco  
*A Different Lens*, 2024  
Steel, glass, slinky & thread
9. Jim Hobbs  
*Polytechniou - When the Order breaks the Fractures Lull*, 2024  
Hand cast porcelain tiles, steel, water, camera with live feed to CRT monitors, audio, speakers, lights, fans
10. Simon Payne  
*Corner Piece*, 2025  
Projectors, video, colours